

**NOTICE!!**

**These documents have been scanned!**

**Do not place un-scanned documents beneath this notice!**

**Do not remove this notice from this file!**

GPO Jacket No. 560-102  
Print Order 61540  
Rise Business Services, LLC  
Job=AZ15 5/16/2019



Box Number= AZ15059



Claim Begin-End: AMC406366-AMC406373

1 Initial Receipt

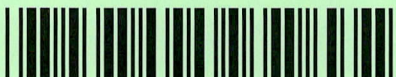

AZ15059-2

AMC406356-AMC407176

**United States Department of the Interior**  
**Bureau of Land Management**  
 LANDS/RECREATION & PLANNING  
 ONE N CENTRAL AVE  
 PHOENIX, AZ 85004 -2203  
 Phone:

Receipt

No: 2310770

<b>Transaction #:</b> 2384007		<b>ENTERED INTO COMPUTER</b>
<b>Date of Transaction:</b> 03/16/2011		
CUSTOMER: <span style="float: right;">MAR 28 2011 PB</span>		
MERRILL PALMER 128 SUNRAY DR LAKE HAVASU CITY, AZ 86403-5814 US		

LINE #	QTY	DESCRIPTION	REMARKS	UNIT PRICE	TOTAL
1	8.00	LOCATABLE MINERALS / MINING CLAIMS- NEW, UNADJUD, ONE OR MORE AUTH NOS / NEW MINING CLAIM PROCESSING FEE \$15 CASES: AMC406366/\$15.00, AMC406367/\$15.00, AMC406368/\$15.00, AMC406369/\$15.00, AMC406370/ \$15.00, AMC406371/\$15.00, AMC406372/\$15.00, AMC406373/\$15.00		- n/a -	120.00
2	8.00	LOCATABLE MINERALS / MINING CLAIMS- NEW, UNADJUD, ONE OR MORE AUTH NOS / NEW MINING CLAIM LOCATION FEE \$34 CASES: AMC406366/\$34.00, AMC406367/\$34.00, AMC406368/\$34.00, AMC406369/\$34.00, AMC406370/ \$34.00, AMC406371/\$34.00, AMC406372/\$34.00, AMC406373/\$34.00		- n/a -	272.00
3	8.00	LOCATABLE MINERALS / MINING CLAIMS- NEW, UNADJUD, ONE OR MORE AUTH NOS / NEW MINING CLAIM MAINT FEE \$140 CASES: AMC406366/\$140.00, AMC406367/\$140.00, AMC406368/\$140.00, AMC406369/\$140.00, AMC406370/ \$140.00, AMC406371/\$140.00, AMC406372/\$140.00, AMC406373/\$140.00		- n/a -	1120.00
<b>TOTAL:</b>					<b>\$1,512.00</b>

PAYMENT INFORMATION			
1	AMOUNT:	1512.00	POSTMARKED: N/A
	TYPE:	CHECK	RECEIVED: 03/15/2011
	CHECK NO:	002633	
	NAME:	PALMER, MERRILL PO BOX 119 OXBOW OR 97840 US	

REMARKS

This receipt was generated by the automated BLM Collections and Billing System and is a paper representation of a portion of the official electronic record contained therein.

**NOTICE!!**

**These documents have been scanned!**

**Do not place un-scanned documents beneath this notice!**

**Do not remove this notice from this file!**

GPO Jacket No. 560-102  
Print Order 61540  
Rise Business Services, LLC  
Job=AZ15 5/16/2019



Box Number= AZ15059



Claim Begin-End: AMC406366-AMC406373

2 Correspondence



AZ15059-2

AMC406356-AMC407176

**NO  
DOCUMENTS  
FOUND**

NO DOCUMENTS FOUND  
NO DOCUMENTS FOUND

**NOTICE!!**

**These documents have been scanned!**

**Do not place un-scanned documents beneath this notice!**

**Do not remove this notice from this file!**

GPO Jacket No. 560-102  
Print Order 61540  
Rise Business Services, LLC  
Job=AZ15 5/16/2019



Box Number= AZ15059



Claim Begin-End: AMC406366-AMC406373

3 Transfers



AZ15059-2

AMC406356-AMC407176

**NO  
DOCUMENTS  
FOUND**

NO DOCUMENTS FOUND  
NO DOCUMENTS FOUND

**NOTICE!!**

**These documents have been scanned!**

**Do not place un-scanned documents beneath this notice!**

**Do not remove this notice from this file!**

GPO Jacket No. 560-102  
Print Order 61540  
Rise Business Services, LLC  
Job=AZ15 5/16/2019



Box Number= AZ15059



Claim Begin-End: AMC406366-AMC406373

4 Miscellaneous



AZ15059-2

AMC406356-AMC407176



Dear People

Please find my check #  
in the amount of \$1512.00 for  
the recording fees with the BLM  
of my 8 federal lode claims  
Bouse 1 through 8.

Could you please send me a copy  
of recorded documents?

Thanks

Merrill Palmer

P.S. - The LA PAZ COUNTY IS NO  
longer open on Friday. I will Record The  
originals with The County on Monday. Since  
my 90 days are almost up I AM sending you  
a copy to record. Please call me at  
541 223 3910 if I need to do something

Else Thanks Merrill Palmer

PHOENIX, ARIZONA

2011 MAR 15 A 11:17

RECEIVED  
BLM AZ STATE OFFICE

**NOTICE!!**

**These documents have been scanned!**

**Do not place un-scanned documents beneath this notice!**

**Do not remove this notice from this file!**

GPO Jacket No. 560-102  
Print Order 61540  
Rise Business Services, LLC  
Job=AZ15 5/16/2019



Box Number= AZ15059



Claim Begin-End: AMC406366-AMC406373

5 Annual Filings



AZ15059-2

AMC406356-AMC407176



This affidavit is made as of the date set forth below pursuant to Arizona Revised Statute §27-208.

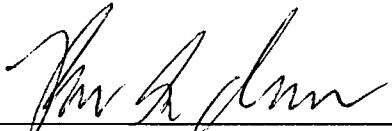

\_\_\_\_\_  
Brian G. Iverson  
Manager of Land, U.S.

The foregoing instrument was acknowledged before me the 12<sup>th</sup> day of July, 2018 by Brian G. Iverson of **Newmont North America Exploration Limited, a Delaware corporation**, on behalf of the corporation.



\_\_\_\_\_  
Notary Public

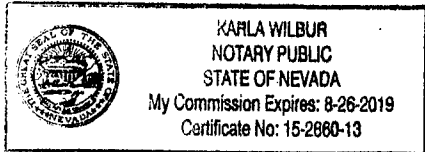

2018 JUL 25 11:20  
PROCTOR

**Exhibit A**  
**Project: Arizona – Bouse**

The following unpatented and patented mining claims located in:  
T. 7 N., R. 17 W., GILA AND SALT RIVER MERIDIAN  
T. 7 N., R. 18 W., GILA AND SALT RIVER MERIDIAN  
LA PAZ COUNTY, ARIZONA

Arizona Mining Claim	Lead Serial No.	Type	Claim Name	Claimant Name	Loc Date
AMC406366 7	AMC406366	LODE	BOUSE #1	PALMER MERRILL	12/16/2010
AMC406367	AMC406366	LODE	BOUSE #2	PALMER MERRILL	12/16/2010
AMC406368	AMC406366	LODE	BOUSE #3	PALMER MERRILL	12/16/2010
AMC406369	AMC406366	LODE	BOUSE #4	PALMER MERRILL	12/16/2010
AMC406370	AMC406366	LODE	BOUSE #5	PALMER MERRILL	12/16/2010
AMC406371	AMC406366	LODE	BOUSE #6	PALMER MERRILL	12/16/2010
AMC406372	AMC406366	LODE	BOUSE #7	PALMER MERRILL	12/16/2010
AMC406373 J	AMC406366	LODE	BOUSE #8	PALMER MERRILL	12/16/2010
AMC406767 7	AMC406767	LODE	BOUSE #9	PALMER MERRILL	01/02/2011
AMC406768	AMC406767	LODE	BOUSE #10	PALMER MERRILL	01/02/2011
AMC406769 J	AMC406767	LODE	BOUSE #11	PALMER MERRILL	01/02/2011
AMC406787 7	AMC406787	LODE	BOUSE 12	PALMER MERRILL	01/05/2011
AMC406788	AMC406787	LODE	BOUSE 13	PALMER MERRILL	01/05/2011
AMC406789	AMC406787	LODE	BOUSE 14	PALMER MERRILL	01/05/2011
AMC406790	AMC406787	LODE	BOUSE 15	PALMER MERRILL	01/05/2011
AMC406791	AMC406787	LODE	BOUSE 16	PALMER MERRILL	01/05/2011
AMC406792	AMC406787	LODE	BOUSE 17	PALMER MERRILL	01/03/2011
AMC406793 J	AMC406787	LODE	BOUSE 18	PALMER MERRILL	01/03/2011
AMC406869 7	AMC406869	LODE	BOUSE #35	PALMER MERRILL	01/10/2011
AMC406870	AMC406869	LODE	BOUSE #34	PALMER MERRILL	01/10/2011
AMC406871	AMC406869	LODE	BOUSE #33	PALMER MERRILL	01/10/2011
AMC406872	AMC406869	LODE	BOUSE #32	PALMER MERRILL	01/10/2011
AMC406873	AMC406869	LODE	BOUSE #31	PALMER MERRILL	01/10/2011
AMC406874 J	AMC406869	LODE	BOUSE #30	PALMER MERRILL	01/10/2011
AMC407176 7	AMC407176	LODE	BOUSE #36	PALMER MERRILL	02/03/2011
AMC407177	AMC407176	LODE	BOUSE #37	PALMER MERRILL	02/03/2011
AMC407178	AMC407176	LODE	BOUSE #38	PALMER MERRILL	02/03/2011
AMC407179 J	AMC407176	LODE	BOUSE #39	PALMER MERRILL	02/03/2011

2010 JUL 25 P 1:19

Arizona Mining Claim	Lead Serial No.	Type	Claim Name	Claimant Name	Loc Date
AMC407180 7	AMC407176	LODE	BOUSE #40	PALMER MERRILL	02/03/2011
AMC407181	AMC407176	LODE	BOUSE #41	PALMER MERRILL	02/03/2011
AMC407182 J	AMC407176	LODE	BOUSE #42	PALMER MERRILL	02/03/2011
AMC412220 7	AMC412220	LODE	B 50	PALMER MERRILL	09/02/2011
AMC412221	AMC412220	LODE	B 51	PALMER MERRILL	09/02/2011
AMC412222	AMC412220	LODE	B 52	PALMER MERRILL	09/02/2011
AMC412223	AMC412220	LODE	B 53	PALMER MERRILL	09/02/2011
AMC412224	AMC412220	LODE	B 54	PALMER MERRILL	09/02/2011
AMC412225	AMC412220	LODE	B 55	PALMER MERRILL	09/02/2011
AMC412226	AMC412220	LODE	B 56	PALMER MERRILL	09/02/2011
AMC412227	AMC412220	LODE	B 57	PALMER MERRILL	09/02/2011
AMC412228	AMC412220	LODE	B 58	PALMER MERRILL	09/02/2011
AMC412229	AMC412220	LODE	B 59	PALMER MERRILL	09/02/2011
AMC412230	AMC412220	LODE	B 60	PALMER MERRILL	09/02/2011
AMC412231	AMC412220	LODE	B 61	PALMER MERRILL	09/02/2011
AMC412232	AMC412220	LODE	B 62	PALMER MERRILL	09/02/2011
AMC412233	AMC412220	LODE	B 63	PALMER MERRILL	09/02/2011
AMC412234	AMC412220	LODE	B 64	PALMER MERRILL	09/02/2011
AMC412235 J	AMC412220	LODE	B 65	PALMER MERRILL	09/02/2011
AMC440236 7	AMC440236	LODE	BOUSE 70	PALMER MERRILL	09/04/2016
AMC440237	AMC440236	LODE	BOUSE 71	PALMER MERRILL	09/04/2016
AMC440238	AMC440236	LODE	BOUSE 72	PALMER MERRILL	09/04/2016
AMC440239	AMC440236	LODE	BOUSE 73	PALMER MERRILL	09/04/2016
AMC440240	AMC440236	LODE	BOUSE 74	PALMER MERRILL	09/04/2016
AMC440241 J	AMC440236	LODE	BOUSE 75	PALMER MERRILL	09/04/2016
AMC447899 7	AMC447899	LODE	B 76	PALMER MERRILL	09/01/2017
AMC447900	AMC447899	LODE	B 77	PALMER MERRILL	09/01/2017
AMC447901	AMC447899	LODE	B 78	PALMER MERRILL	09/01/2017
AMC447902	AMC447899	LODE	B 79	PALMER MERRILL	09/01/2017
AMC447903	AMC447899	LODE	B 80	PALMER MERRILL	09/01/2017
AMC447904	AMC447899	LODE	B 81	PALMER MERRILL	09/01/2017
AMC447905	AMC447899	LODE	B 82	PALMER MERRILL	09/01/2017
AMC447906	AMC447899	LODE	B 19	PALMER MERRILL	09/01/2017
AMC447907	AMC447899	LODE	B 20	PALMER MERRILL	09/01/2017
AMC447908	AMC447899	LODE	B 21	PALMER MERRILL	09/01/2017
AMC447909 J	AMC447899	LODE	B 22	PALMER MERRILL	09/01/2017

ARIZONA – BOUSE 2018/2019 FILING

PHOENIX, ARIZONA  
 2019 JUL 25 P 1:19

Arizona Mining Claim	Lead Serial No.	Type	Claim Name	Claimant Name	Loc Date
AMC447910 7	AMC447899	LODE	B 23	PALMER MERRILL	09/01/2017
AMC447911 7	AMC447899	LODE	B 24	PALMER MERRILL	09/01/2017

RECEIVED  
 2018 JUL 25 P 1:19  
 PHOENIX, ARIZONA  
 RECORDS OFFICE

**United States Department of the Interior**  
**Bureau of Land Management**  
 DIV OF LANDS, MINRLS & ENERGY  
 ONE N CENTRAL AVE  
 PHOENIX, AZ 85004 -4427  
 Phone: 602-417-9200

Receipt

No: 4219331

<b>Transaction #:</b> 4334513	
<b>Date of Transaction:</b> 07/25/2018	
CUSTOMER:	
NEWMONT NORTH AMERICA EXPL LTD 1655 MOUNTAIN CITY HWY ELKO,NV 89801-2800 US	

LINE #	QTY	DESCRIPTION	REMARKS	UNIT PRICE	TOTAL
1	1.00	LOCATABLE MINERALS / MINING CLAIMS- NOT NEW-UNADJUD, ONE AUTH NO. ONLY / MINING CLAIM MONEY RECEIVED CASES: AMC406366/\$10230.00	2019 MAINT (66)	- n/a -	10230.00
<b>TOTAL:</b>					<b>\$10,230.00</b>

PAYMENT INFORMATION			
1	AMOUNT:	10230.00	POSTMARKED: N/A
	TYPE:	CHECK	RECEIVED: 07/25/2018
	CHECK NO:	2000036606	
	NAME:	NEWMONT NORTH AMERICA EXPL LTD 1655 MOUNTAIN CITY HWY ELKO NV 89801-2800 US	

REMARKS

This receipt was generated by the automated BLM Collections and Billing System and is a paper representation of a portion of the official electronic record contained therein.



406366

406767

406787

406869

407176

412220

440236

Dear People

Inclosed please find my check #2050  
in the amount of \$ 8,215<sup>00</sup> for the  
maintenance fees for 53 lode mining  
claims located in the county of La Paz,  
Arizona and more fully described by  
an attached 3 page list.

Please return a receipt to me at  
Merrill Palmer

Po Box 119

Oxbow, OR. 97840

Phone 541 785 3543

2017 AUG -4 P 3:05  
MERRILL PALMER

Thank you very much!

Merrill Palmer

ENTERED  
AUG 08 2017  
BY: RAM

**BOUSE CLAIMS AMC. NUMBER**

CLAIM NAME	AMC. NUMBER	SECTION	TOWNSHIP	RANGE
BOUSE #1	AMC406366 7	18	T7N	R17W
BOUSE #2	AMC406367	18	T7N	R17W
BOUSE #3	AMC406368	18	T7N	R17W
BOUSE #4	AMC406369	18	T7N	R17W
BOUSE #5	AMC406370	18	T7N	R17W
BOUSE #6	AMC406371	18	T7N	R17W
BOUSE #7	AMC406372	18	T7N	R17W
BOUSE #8	AMC406373 }	18	T7N	R17W
BOUSE #9	AMC406767 7	17-18	T7N	R17W
BOUSE #10	AMC406768	17	T7N	R17W
BOUSE #11	AMC406769 }	17	T7N	R17W
BOUSE #12	AMC406787 7	17	T7N	R17W
BOUSE #13	AMC406788	17	T7N	R17W
BOUSE #14	AMC406789	17	T7N	R17W
BOUSE #15	AMC406790	18	T7N	R17W
BOUSE #16	AMC406791	18	T7N	R17W
BOUSE #17	AMC406792	18	T7N	R17W
BOUSE # 18	AMC406793 }	18	T7N	R17W
BOUSE #30	AMC406874 7	13	T7N	R18W
BOUSE #31	AMC406873	13	T7N	R18W
BOUSE #32	AMC406872	13	T7N	R18W
BOUSE #33	AMC406871 }	13	T7N	R18W

Page 1 of 3

# 393387

Total Claims This page 22

2011 AUG -4 P 3:07

CLAIM NAME	AMC NUMBER	SECTION	TOWNSHIP	RANGE
BOUSE #34	AMC406870	13	T7N	R18W
BOUSE #35	AMC406869	13	T7N	R18W
BOUSE #36	AMC407176	24	T7N	R18W
BOUSE #37	AMC407177	24	T7N	R18W
BOUSE #38	AMC407178	24	T7N	R18W
BOUSE #39	AMC407179	24	T7N	R18W
BOUSE #40	AMC407180	24	T7N	R18W
BOUSE #41	AMC407181	24-19	T7N	R18W-R17W
BOUSE #42	AMC407182	24-19	T7N	R18W-R17W

6 New Claims 2016

AMC440236 14 0070N 0180W 013 SE  
 AMC440237 14 0070N 0180W 013 SE  
 AMC440238 14 0070N 0170W 018 SW  
 AMC440239 14 0070N 0170W 018 SW  
 AMC440240 14 0070N 0170W 018 SW  
 AMC440241 14 0070N 0170W 018 SW

BOUSE 70  
 BOUSE 71  
 BOUSE 72  
 BOUSE 73  
 BOUSE 74  
 BOUSE 75

PALMER MERRILL  
 PALMER MERRILL  
 PALMER MERRILL  
 PALMER MERRILL  
 PALMER MERRILL  
 PALMER MERRILL

AMC NUMBER	LODE	ACTIVE	DATE	YEAR
AMC440236	LODE	ACTIVE	09/04/2016	2017
AMC440236	LODE	ACTIVE	09/04/2016	2017
AMC440236	LODE	ACTIVE	09/04/2016	2017
AMC440236	LODE	ACTIVE	09/04/2016	2017
AMC440236	LODE	ACTIVE	09/04/2016	2017
AMC440236	LODE	ACTIVE	09/04/2016	2017

Page 2 of 3

Total Claims This Page 15

2017 / 10 / 11 P. 3: 05

**EXHIBIT A**

The "PROPERTY" consists of those certain unpatented lode mining claims situated in Sections 13 and 24, Township 7 North, Range 18 West, and Sections 7, 8, 17, 18 and 19, Township 7 North, Range 17 West, G&SR Mer., in the Bouse (Plomosa) Mining District, La Paz County, Arizona, the names of which and the place of record of the location notices thereof in the official records of the county recorder and the authorized office of the Bureau of Land Management are as follows:

<u>Name of Claim</u>	<u>County Records Instrument Number</u>	<u>BLM Serial # AMC</u>
B-50	2011-04526	412220 7
B-51	2011-04525	412221
B-52	2011-04524	412222
B-53	2011-04523	412223
B-54	2011-04522	412224
B-55	2011-04521	412225
B-56	2011-04520	412226
B-57	2011-04519	412227
B-58	2011-04518	412228
B-59	2011-04517	412229
B-60	2011-04516	412230
B-61	2011-04515	412231
B-62	2011-04514	412232
B-63	2011-04513	412233
B-64	2011-04512	412234
B-65	2011-04511	412235 J

Page 3 of 3

Total Claims This page 16

Grand Total All Three Pages = 53

2011 AUG -11 PM 3:05

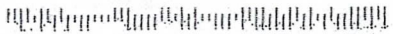

RECEIVED  
2017 AUG -4 P 3:05  
PHOENIX, ARIZONA



To: U.S. DEPT. OF INTERIOR  
BUREAU OF LAND MANAGEMENT  
ARIZONA STATE OFFICE  
ONE NORTH CENTRAL AVENUE SUITE 800  
PHOENIX, AZ. 85004-4487



Label 107R, January 2008



USPS TRACKING #



9114 9999 4431 4908 0773 45

LAB400R Aug. 2013  
7690-17-000-0669

**United States Department of the Interior**  
**Bureau of Land Management**  
 DIV OF LANDS, MINRLS & ENERGY  
 ONE N CENTRAL AVE  
 PHOENIX, AZ 85004 -4427  
 Phone: 602-417-9200

Receipt

No: 3923879

<b>Transaction #:</b> 4033398	
<b>Date of Transaction:</b> 08/07/2017	
CUSTOMER:	
MERRILL I PALMER PO BOX 119 OXBOW,OR 97840-0119 US	

LINE #	QTY	DESCRIPTION	REMARKS	UNIT PRICE	TOTAL
1	1.00	LOCATABLE MINERALS / MINING CLAIMS- NOT NEW-UNADJUD,ONE AUTH NO. ONLY / MINING CLAIM MONEY RECEIVED CASES: AMC406366/\$8215.00	MAINT 2018/53	- n/a -	8215.00
<b>TOTAL:</b>					<b>\$8,215.00</b>

PAYMENT INFORMATION			
1	AMOUNT:	8215.00	POSTMARKED: 08/01/2017
	TYPE:	CHECK	RECEIVED: 08/04/2017
	CHECK NO:	2050	
	NAME:	PALMER, MERRILL I PO BOX 119 OXBOW OR 97840-0119 US	

REMARKS

This receipt was generated by the automated BLM Collections and Billing System and is a paper representation of a portion of the official electronic record contained therein.

412220 406366 406767

**APPENDIX I**

BOUSE CLAIMS AMC. NUMBER

CLAIM NAME	AMC. NUMBER	SECTION	TOWNSHIP	RANGE
1x BOUSE #1	AMC406366 7	18	T7N	R17W
2x BOUSE #2	AMC406367	18	T7N	R17W
3x BOUSE #3	AMC406368	18	T7N	R17W
4x BOUSE #4	AMC406369	18	T7N	R17W
5x BOUSE #5	AMC406370	18	T7N	R17W
6x BOUSE #6	AMC406371	18	T7N	R17W
7x BOUSE #7	AMC406372	18	T7N	R17W
8x BOUSE #8	AMC406373 ]	18	T7N	R17W
9x BOUSE #9	AMC406767 7	17-18	T7N	R17W
10x BOUSE #10	AMC406768	17	T7N	R17W
11x BOUSE #11	AMC406769 ]	17	T7N	R17W
12x BOUSE #12	AMC406787 7	17	T7N	R17W
13x BOUSE #13	AMC406788	17	T7N	R17W
14x BOUSE #14	AMC406789	17	T7N	R17W
15x BOUSE #15	AMC406790	18	T7N	R17W
16x BOUSE #16	AMC406791	18	T7N	R17W
17x BOUSE #17	AMC406792	18	T7N	R17W
18x BOUSE #18	AMC406793 ]	18	T7N	R17W
19x BOUSE #30	AMC406874 7	13	T7N	R18W
20x BOUSE #31	AMC406873	13	T7N	R18W
21x BOUSE #32	AMC406872 ]	13	T7N	R18W

RECEIVED  
BLM AZ STATE OFFICE  
2016 AUG -5 P 3:11  
PHOENIX, ARIZONA

406787  
406869  
407176

INTERED  
AUG 09 2016  
BY: R Am

RECEIPT # 3623211

**APPENDIX I continued:**

<u>CLAIM NAME</u>	<u>AMC NUMBER</u>	<u>SECTION</u>	<u>TOWNSHIP</u>	<u>RANGE</u>
22 <del>x</del> BOUSE #33	AMC406871	13	T7N	R18W
23 <del>x</del> BOUSE #34	AMC406870	13	T7N	R18W
24 <del>x</del> BOUSE #35	AMC406869	13	T7N	R18W
25 <del>x</del> BOUSE #36	AMC407176	24	T7N	R18W
26 <del>x</del> BOUSE #37	AMC407177	24	T7N	R18W
<del>27 <del>x</del> BOUSE #38</del>	<del>AMC407178</del>	<del>24</del>	<del>T7N</del>	<del>R18W</del>
28 <del>x</del> BOUSE #39	AMC407179	24	T7N	R18W
29 <del>x</del> BOUSE #40	AMC407180	24	T7N	R18W
30 <del>x</del> BOUSE #41	AMC407181	24-19	T7N	R18W-R17W
31 <del>x</del> BOUSE #42	AMC407182	24-19	T7N	R18W-R17W

PHOENIX, ARIZONA

2016 AUG -5 P 3:11

RECEIVED  
BLM AZ STATE OFFICE



## EXHIBIT A

The "PROPERTY" consists of those certain unpatented lode mining claims situated in Sections 13 and 24, Township 7 North, Range 18 West, and Sections 7, 8, 17, 18 and 19, Township 7 North, Range 17 West, G&SR Mer., in the Bouse (Plomosa) Mining District, La Paz County, Arizona, the names of which and the place of record of the location notices thereof in the official records of the county recorder and the authorized office of the Bureau of Land Management are as follows:

<u>Name of Claim</u>	<u>County Records Instrument Number</u>	<u>BLM Serial # AMC</u>
32 ✓ B-50	2011-04526	412220 7
33 ✓ B-51	2011-04525	412221
34 ✓ B-52	2011-04524	412222
35 ✓ B-53	2011-04523	412223
36 ✓ B-54	2011-04522	412224
37 ✓ B-55	2011-04521	412225
38 ✓ B-56	2011-04520	412226
39 × B-57	2011-04519	412227
40 × B-58	2011-04518	412228
41 × B-59	2011-04517	412229
42 × B-60	2011-04516	412230
43 × B-61	2011-04515	412231
44 ↑ B-62	2011-04514	412232
45 × B-63	2011-04513	412233
46 × B-64	2011-04512	412234
47 × B-65	2011-04511	412235 }

PHOENIX, ARIZONA

2011 AUG - 5 P 3 12

RECEIVED  
BLM AZ STATE OFFICE

PRESS FIRMLY TO SEAL

# PRIORITY® ★ MAIL ★

- DATE OF DELIVERY SPECIFIED\*
- USPS TRACKING™ INCLUDED\*
- INSURANCE INCLUDED\*
- PICKUP AVAILABLE  
\* Domestic only

WHEN USED INTERNATIONALLY,  
A CUSTOMS DECLARATION  
LABEL MAY BE REQUIRED.

RECEIVED  
OWEN STATE OFFICE  
12016 AUG - 5 P 3 10  
PHOENIX, ARIZONA



FROM:

**PRIORITY®  
MAIL**  
UNITED STATES POSTAL SERVICE

For Domestic  
and International Use



From M. PALMER  
PO BOX 119  
Oxbow OR  
97840

TO US DEPT. OF INTERIOR  
Bureau of LAND MANAGEMENT  
ARIZONA STATE OFFICE  
OWEN CENTRAL AVE  
PHOENIX AZ Suite 800  
85004-4427

Label 228, January 2008

UNITED STATES  
POSTAL SERVICE®

USPS TRACKING #



9114 9999 4431 4888 0818 37

Label 228, Aug. 2013  
7890-17-000-0689

July 2013  
625 x 15.125

VISIT US AT [USPS.COM](http://USPS.COM)®  
ORDER FREE SUPPLIES ONLINE

UNITED STATES  
POSTAL SERVICE.

DuPont™ Tyvek®  
Protect What's Inside.™

This packaging is the property of the U.S. Postal Service® and is provided solely for use in sending Priority Mail® shipments. Misuse may be a violation of federal law. This packaging is not for resale. EP14 © U.S. Postal Service, July 2013; All rights reserved.

TYVEK® IS RECYCLABLE.  
HDPE © 2003, DUPONT™ AND TYVEK® ARE TRADEMARKS OF DUPONT.

PRESS FIRMLY TO SEAL

Merrill Palmer  
P.O. Box 119  
Oxbow, Oregon  
97840

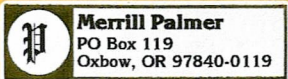

RECEIVED  
BLM AZ STATE OFFICE

2016 AUG -5 P 3 11

PHOENIX, ARIZONA

To U S Dept of Interior  
Bureau of Land Management  
Arizona State office  
ONE North Central Ave. Suite 800  
Phoenix, Arizona 85004-4427

*attens maintenance fee recording!*

**United States Department of the Interior**  
**Bureau of Land Management**  
 DIV OF LANDS, MINRLS & ENERGY  
 ONE N CENTRAL AVE  
 PHOENIX, AZ 85004 -4427  
 Phone: 602-417-9200

Receipt

No: 3623211

<b>Transaction #:</b> 3726941	
<b>Date of Transaction:</b> 08/08/2016	
CUSTOMER:	
MERRILL I PALMER PO BOX 119 OXBOW,OR 97840-0119 US	

LINE #	QTY	DESCRIPTION	REMARKS	UNIT PRICE	TOTAL
1	1.00	LOCATABLE MINERALS / MINING CLAIMS- NOT NEW-UNADJUD,ONE AUTH NO. ONLY / MINING CLAIM MONEY RECEIVED CASES: AMC406366/\$7285.00	MAINT FEE 2017 - 47	- n/a -	7285.00
<b>TOTAL:</b>					<b>\$7,285.00</b>

PAYMENT INFORMATION			
1	AMOUNT:	7285.00	POSTMARKED: N/A
	TYPE:	CHECK	RECEIVED: 08/05/2016
	CHECK NO:	1724	
	NAME:	PALMER, MERRILL I PO BOX 119 OXBOW OR 97840-0119 US	

REMARKS

This receipt was generated by the automated BLM Collections and Billing System and is a paper representation of a portion of the official electronic record contained therein.

Dear People

Inclosed please find my check #1724  
for \$7,285<sup>00</sup> dollars as payment of 2017  
maintenance fees for 47 lode mining  
claims located in La Paz, County, Arizona  
and fully described by my **inclosed 3 page**  
list

My home phone is 541-785 3543.

Please send my receipt to:

**Merrill Palmer**  
PO Box 119  
Oxbow, OR 97840-0119

Thank you Merrill Palmer

**RECEIVED**  
BLM AZ STATE OFFICE  
AUG - 5 P 3 11  
PHOENIX, ARIZONA

406787 412220  
406869  
407176 406306  
406767

Dear People

Please find my check for \$7285<sup>00</sup> dollars in payment for 47 lode mining claims maintenance fees of 155<sup>00</sup> per claim.

I have attached two different claim lists one list titled "Bouse Claims AMC numbers" has 31 lode claims listed that are currently in my name of Merrill Palmer Locator.

The other list of 16 lode claims is titled "Exhibit A" B50 through B65 I have recently purchased from AVEN ASSOCIATES LLC.

My understanding is AVEN is currently recording this transaction with the La Paz County AZ and then will record the same quit claim deed with your BLM office. I have enclosed a copy for your files and wish to pay the maintenance fees on these 16 claims together with the 31 claims on the other list for a total of 47 lode claims.

If there is any problem my phone # is 541 785 3543. I am currently in Oregon.

Please make my receipts to:

Merrill Palmer  
P.O. Box 119  
Oxbow, OR. 97840

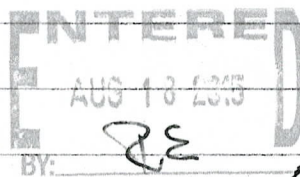

Thank you very much!  
Merrill Palmer

RECEIVED  
BLM ARIZONA OFFICE  
2015 AUG 10 P 3:30  
PHOENIX, ARIZONA

**EXHIBIT A**

The "PROPERTY" consists of those certain unpatented lode mining claims situated in Sections 13 and 24, Township 7 North, Range 18 West, and Sections 7, 8, 17, 18 and 19, Township 7 North, Range 17 West, G&SR Mer., in the Bouse (Plomosa) Mining District, La Paz County, Arizona, the names of which and the place of record of the location notices thereof in the official records of the county recorder and the authorized office of the Bureau of Land Management are as follows:

<u>Name of Claim</u>	<u>County Records Instrument Number</u>	<u>BLM Serial # AMC</u>
B-50	2011-04526	412220
B-51	2011-04525	412221
B-52	2011-04524	412222
B-53	2011-04523	412223
B-54	2011-04522	412224
B-55	2011-04521	412225
B-56	2011-04520	412226
B-57	2011-04519	412227
B-58	2011-04518	412228
B-59	2011-04517	412229
B-60	2011-04516	412230
B-61	2011-04515	412231
B-62	2011-04514	412232
B-63	2011-04513	412233
B-64	2011-04512	412234
B-65	2011-04511	412235

RECEIVED  
BLM AZ STATE OFFICE  
2015 AUG 10 P 3:31  
PHOENIX, ARIZONA

RECEIPT # 3364288





## BOUSE CLAIMS AMC. NUMBER

CLAIM NAME	AMC. NUMBER	SECTION	TOWNSHIP	RANGE
BOUSE #1	AMC406366	18	T7N	R17W
BOUSE #2	AMC406367	18	T7N	R17W
BOUSE #3	AMC406368	18	T7N	R17W
BOUSE #4	AMC406369	18	T7N	R17W
BOUSE #5	AMC406370	18	T7N	R17W
BOUSE #6	AMC406371	18	T7N	R17W
BOUSE #7	AMC406372	18	T7N	R17W
BOUSE #8	AMC406373	18	T7N	R17W
BOUSE #9	AMC406767	17-18	T7N	R17W
BOUSE #10	AMC406768	17	T7N	R17W
BOUSE #11	AMC406769	17	T7N	R17W
BOUSE #12	AMC406787	17	T7N	R17W
BOUSE #13	AMC406788	17	T7N	R17W
BOUSE #14	AMC406789	17	T7N	R17W
BOUSE #15	AMC406790	18	T7N	R17W
BOUSE #16	AMC406791	18	T7N	R17W
BOUSE #17	AMC406792	18	T7N	R17W
BOUSE # 18	AMC406793	18	T7N	R17W
BOUSE #30	AMC406874	13	T7N	R18W
BOUSE #31	AMC406873	13	T7N	R18W
BOUSE #32	AMC406872	13	T7N	R18W
BOUSE #33	AMC406871	13	T7N	R18W

RECEIVED  
BLM A7 OFFICE  
2015 AUG 10 P 3:31  
PHOENIX, ARIZONA

RECEIPT # 3364288

CLAIM NAME	AMC NUMBER	SECTION	TOWNSHIP	RANGE
BOUSE #34	AMC406870	13	T7N	R18W
BOUSE #35	AMC406869	13	T7N	R18W
BOUSE #36	AMC407176	24	T7N	R18W
BOUSE #37	AMC407177	24	T7N	R18W
BOUSE #38	AMC407178	24	T7N	R18W
BOUSE #39	AMC407179	24	T7N	R18W
BOUSE #40	AMC407180	24	T7N	R18W
BOUSE #41	AMC407181	24-19	T7N	R18W-R17W
BOUSE #42	AMC407182	24-19	T7N	R18W-R17W

RECEIVED  
BLM A7 STATE OFFICE  
2015 AUG 10 P 3:31  
PHOENIX, ARIZONA

Merrill Palmer  
P.O. Box 119  
Oxbow, OR. 97840



Merrill Palmer  
Box 119  
Oxbow, OR 97840-0119

PLACE STICKER AT TOP OF ENVELOPE TO THE RIGHT  
OF THE RETURN ADDRESS. FOLD AT DOTTED LINE

**CERTIFIED MAIL**



7015 1730 0002 1028 0997

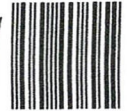

1000

85004

U.S. PO  
PAID  
BAKER  
978  
AUG 03,  
AMO

\$7

001160

RECEIVED  
BLM AZ STATE OFFICE

2015 AUG 10 P 3:31

PHOENIX, ARIZONA

To U.S. Dept of Interior  
ARIZONA STATE OFFICE  
ONE NORTH CENTRAL AVENUE  
SUITE 800  
PHOENIX, AZ. 85004-4427

MINING ACCOUNTS:

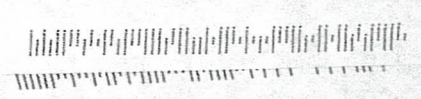

**United States Department of the Interior**  
**Bureau of Land Management**  
LANDS/RECREATION & PLANNING  
ONE N CENTRAL AVE  
PHOENIX, AZ 85004 -2203  
Phone: 602-417-9200

Receipt

No: 3364288

<b>Transaction #:</b> 3462333	
<b>Date of Transaction:</b> 08/11/2015	
CUSTOMER:	
MERRILL I PALMER PO BOX 119 OXBOW,OR 97840-0119 US	

LINE #	QTY	DESCRIPTION	REMARKS	UNIT PRICE	TOTAL
1	1.00	LOCATABLE MINERALS / MINING CLAIMS-NOT NEW-UNADJUD,ONE AUTH NO. ONLY / MINING CLAIM MONEY RECEIVED <b>CASES:</b> AMC412220/\$7285.00	MAINT FEE PYMNT (47) 2016	- n/a -	7285.00
<b>TOTAL:</b>					<b>\$7,285.00</b>

PAYMENT INFORMATION			
1	AMOUNT:	7285.00	POSTMARKED: 08/05/2015
	TYPE:	CHECK	RECEIVED: 08/10/2015
	CHECK NO:	1077	
	NAME:	PALMER, MERRIL I PO BOX 119 OXBOW OR 97840-0119 US	

REMARKS

This receipt was generated by the automated BLM Collections and Billing System and is a paper representation of a portion of the official electronic record contained therein.

**AVEN Associates LLC**

L. Clark Arnold  
Alan F. Edwards  
Steven D. Van Nort

412220

406366  
406787  
406869  
407176

7400 North Oracle Road  
Suite 131  
Tucson, Arizona 85704  
520 797-1393  
520 742-7280 Facsimile  
clark.arnold@yaneminerals.com

August 11, 2014

Bureau of Land Management  
Arizona State Office  
One North Central Avenue, Suite 800  
Phoenix, AZ 85004-4427

Gentlemen/Ladies,

Enclosed please find our check #1012 in the amount of \$7,285.00 to cover annual assessment fees for assessment year 2015 for the 47 claims listed in Exhibit A, which is also included. The receipt for this payment should be sent to the address shown in the letterhead above.

If I can be of assistance, please get in touch via the contact information provided.

Yours truly,



L. Clark Arnold  
AVEN Associates LLC  
520 909-2885 cell

NO. OF CLAIMS 47  
AMOUNT \$7285.00  
RECEIPT NO. 3101116  
INIT. CA  
**\*\* BLM-ASO\*\***

RECEIVED  
BLM AZ STATE OFFICE  
2014 AUG 13 P 1:17  
PHOENIX, ARIZONA

ENTERED  
AUG 15 2014  
BY: RE

E A - List of Mining Claims

Claim Name	AMC No.	La Paz Co. Ref.	Section	Twnshp	Range
BOUSE #1	AMC406366	201101207	18	T7N	R17W
BOUSE #2	AMC406367	201101208	18	T7N	R17W
BOUSE #3	AMC406368	201101209	18	T7N	R17W
BOUSE #4	AMC406369	201101210	18	T7N	R17W
BOUSE #5	AMC406370	201101211	18	T7N	R17W
BOUSE #6	AMC406371	201101212	18	T7N	R17W
BOUSE #7	AMC406372	201101213	18	T7N	R17W
BOUSE #8	AMC406373	201101214	18	T7N	R17W
BOUSE #9	AMC406767	201101393	17-18	T7N	R17W
BOUSE #10	AMC406768	201101392	17	T7N	R17W
BOUSE #11	AMC406769	201101391	17	T7N	R17W
BOUSE #12	AMC406787	201101430	17	T7N	R17W
BOUSE #13	AMC406788	201101431	17	T7N	R17W
BOUSE #14	AMC406789	201101432	17	T7N	R17W
BOUSE #15	AMC406790	201101433	18	T7N	R17W
BOUSE #16	AMC406791	201101434	18	T7N	R17W
BOUSE #17	AMC406792	201101439	18	T7N	R17W
BOUSE #18	AMC406793	201101438	18	T7N	R17W
BOUSE #30	AMC406874	201101553	13	T7N	R18W
BOUSE #31	AMC406873	201101554	13	T7N	R18W
BOUSE #32	AMC406872	201101555	13	T7N	R18W
BOUSE #33	AMC406871	201101556	13	T7N	R18W
BOUSE #34	AMC406870	201101557	13	T7N	R18W
BOUSE #35	AMC406869	201101558	13	T7N	R18W
BOUSE #36	AMC407176	201101833	24	T7N	R18W
BOUSE #37	AMC407177	201101832	24	T7N	R18W
BOUSE #38	AMC407178	201101831	24	T7N	R18W
BOUSE #39	AMC407179	201101830	24	T7N	R18W
BOUSE #40	AMC407180	201101829	24	T7N	R18W
BOUSE #41	AMC407181	201101828	24-19	T7N	R18W-R17W
BOUSE #42	AMC407182	201101827	24-19	T7N	R18W-R17W
B-50	AMC412220	201104526	13	T7N	R18W
B-51	AMC412221	201104525	13	T7N	R18W
B-52	AMC412222	201104524	13	T7N	R18W
B-53	AMC412223	201104523	13	T7N	R18W
B-54	AMC412224	201104522	13	T7N	R18W
B-55	AMC412225	201104521	13	T7N	R18W
B-56	AMC412226	201104520	13	T7N	R18W
B-57	AMC412227	201104519	19	T7N	R18W
B-58	AMC412228	201104518	19	T7N	R17W
B-59	AMC412229	201104517	19	T7N	R17W
B-60	AMC412230	201104516	19	T7N	R17W
B-61	AMC412231	201104515	19	T7N	R17W
B-62	AMC412232	201104514	24	T7N	R18W
B-63	AMC412233	201104513	8	T7N	R17W
B-64	AMC412234	201104512	8	T7N	R17W
B-65	AMC412235	201104511	8	T7N	R17W

RECEIVED  
 BLM AZ STATE OFFICE  
 2014 AUG 13 P 1:17  
 PHOENIX, ARIZONA

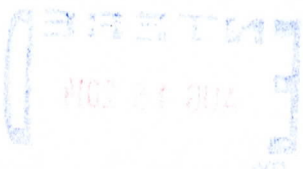

**United States Department of the Interior**  
**Bureau of Land Management**  
 LANDS/RECREATION & PLANNING  
 ONE N CENTRAL AVE  
 PHOENIX, AZ 85004 -2203  
 Phone: 602-417-9200

Receipt

No: 3101116

<b>Transaction #:</b> 3192669	
<b>Date of Transaction:</b> 08/14/2014	
CUSTOMER:	
AVEN ASSOCIATES LLC 7400 N ORACLE RD STE 131 TUCSON, AZ 85704-6339 US	

LINE #	QTY	DESCRIPTION	REMARKS	UNIT PRICE	TOTAL
1	1.00	LOCATABLE MINERALS / MINING CLAIMS-NOT NEW-UNADJUD, ONE AUTH NO. ONLY / MINING CLAIM MONEY RECEIVED CASES: AMC406366/\$7285.00	MAINT FEE PYMNT (47) 2015	- n/a -	7285.00
<b>TOTAL:</b>					<b>\$7,285.00</b>

PAYMENT INFORMATION					
1	AMOUNT:	7285.00	POSTMARKED:	08/12/2014	
	TYPE:	CHECK	RECEIVED:	08/13/2014	
	CHECK NO:	1012			
	NAME:	AVEN ASSOCIATES LLC 7400 N ORACLE RD STE 131 TUCSON AZ 85704-6339 US			

REMARKS

This receipt was generated by the automated BLM Collections and Billing System and is a paper representation of a portion of the official electronic record contained therein.

$$\begin{array}{r} 15 \\ \hline 47 \overline{) 7285} \\ \underline{47} \phantom{0} \\ 258 \phantom{0} \\ \underline{235} \phantom{0} \\ 235 \phantom{0} \\ \underline{235} \\ 0 \end{array}$$



406366

406787

407176

412220

# AVEN Associates LLC

L. Clark Arnold  
Alan F. Edwards  
Steven D. Van Nort

7400 North Oracle Road  
Suite 131  
Tucson, Arizona 85704  
520 797-1393  
520 742-7280 Facsimile  
[clark.arnold@vaneminerals.com](mailto:clark.arnold@vaneminerals.com)

August 6, 2013

Bureau of Land Management  
Arizona State Office  
One North Central Avenue, Suite 800  
Phoenix, AZ 85004-4427

RECEIVED  
BLM AZ STATE OFFICE  
2013 AUG - 7 AM 11:46  
PHOENIX, ARIZONA

Gentlemen/Ladies,

Enclosed please find my check #3788 in the amount of \$3,920 to cover annual assessment fees for assessment year 2014 for the 28 claims listed in Exhibit A, which is also included. The receipt for this payment should be sent to the address shown in the letterhead above.

If I can be of assistance, please get in touch via the contact information provided.

Yours truly,

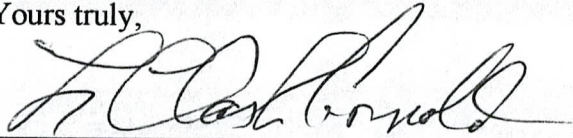

L. Clark Arnold  
AVEN Associates LLC  
520 909-2885 cell

NO. OF CLAIMS 28  
AMOUNT \$3,920.00  
RECEIPT NO. 2850028  
INIT. AA  
\*\* BLM-ASO\*\*

ENTERED IN COMPUTER

RE 8-19-13

ANK 406366

Exhibit A - List of Mining Claims

Claim Number	AMC Number	La Paz Co. Ref.	Section	Twنشp	Range
Bouse #1	AMC406366	201101207	18	T7N	R17W
Bouse #2	AMC406367	201101208	18	T7N	R17W
Bouse #3	AMC406368	201101209	18	T7N	R17W
Bouse #4	AMC406369	201101210	18	T7N	R17W
Bouse #5	AMC406370	201101211	18	T7N	R17W
Bouse #6	AMC406371	201101212	18	T7N	R17W
Bouse #7	AMC406372	201101213	18	T7N	R17W
Bouse #8	<u>AMC406373</u>	201101214	18	T7N	R17W
Bouse #12	AMC406787	201101430	17	T7N	R17W
Bouse #13	AMC406788	201101431	17	T7N	R17W
Bouse #14	AMC406789	201101432	17	T7N	R17W
Bouse #15	AMC406790	201101433	18	T7N	R17W
Bouse #16	AMC406791	201101434	18	T7N	R17W
Bouse #17	AMC406792	201101439	18	T7N	R17W
Bouse #18	<u>AMC406793</u>	201101438	18	T7N	R17W
Bouse #36	AMC407176	201101833	24	T7N	R18W
Bouse #37	<u>AMC407177</u>	201101832	24	T7N	R18W
Bouse #42	<u>AMC407182</u>	201101827	24-19	T7N	R18W-R17W
B-53	AMC412223	201101827	24-19	T7N	R18W-R17W
B-54	<u>AMC412224</u>	201101827	24-19	T7N	R18W-R17W
B-57	<u>AMC412227</u>	201104519	19	T7N	R18W
B-58	AMC412228	201104518	19	T7N	R17W
B-59	AMC412229	201104517	19	T7N	R17W
B-60	AMC412230	201104516	19	T7N	R17W
B-61	AMC412231	201104515	19	T7N	R17W
B-63	AMC412233	201104513	8	T7N	R17W
B-64	AMC412234	201104512	8	T7N	R17W
B-65	AMC412235	201104511	8	T7N	R17W

RECEIVED  
 BLM AZ STATE OFFICE  
 PHOENIX, ARIZONA  
 2013 AUG -7 AM 11:46

AVEN ASSOCIATES LLC  
7400 N. ORACLE RD #131  
Tucson, AZ 85704

PHOENIX AZ 852

06 AUG 2013 PM 3 L



RECEIVED  
BLM AZ STATE OFFICE  
2013 AUG -7 AM 11:46  
PHOENIX, ARIZONA

U.S. BUREAU OF LAND MGMT.  
ONE NORTH CENTRAL AVE SUITE 800  
PHOENIX, AZ 85004-4427

ASSESSMENT FEES

85004442700



AVEN ASSOCIATES LLC  
7400 N. ORACLE RD #131  
Tucson, AZ 85704

PHOENIX AZ 852

06 AUG 2013 PM 3:1



RECEIVED  
BLM AZ OFFICE

2013 AUG -7 01 11:46

PHOENIX, ARIZONA

U.S. BUREAU OF LAND MGMT.  
ONE NORTH CENTRAL AVE SUITE 800  
PHOENIX, AZ-85004-4427

ASSESSMENT FEES

85004442700

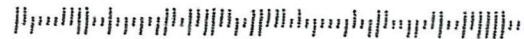

**United States Department of the Interior**  
**Bureau of Land Management**  
 LANDS/RECREATION & PLANNING  
 ONE N CENTRAL AVE  
 PHOENIX, AZ 85004 -2203  
 Phone: 602-417-9200

Receipt

No: 2850028

<b>Transaction #:</b> 2935748	
<b>Date of Transaction:</b> 08/08/2013	
<b>CUSTOMER:</b>	
AVEN ASSOCIATES LLC 7400 N ORACLE RD TUCSON, AZ 85704-6331 US	

LINE #	QTY	DESCRIPTION	REMARKS	UNIT PRICE	TOTAL
1	1.00	LOCATABLE MINERALS / MINING CLAIMS-NOT NEW-UNADJUD, ONE AUTH NO. ONLY / MINING CLAIM MONEY RECEIVED CASES: AMC406366/\$3920.00	MAINT FEE PYMNT (28) 2014	- n/a -	14 3920.00
<b>TOTAL:</b>					<b>\$3,920.00</b>

PAYMENT INFORMATION			
1	AMOUNT:	3920.00	POSTMARKED: 08/06/2013
	TYPE:	CHECK	RECEIVED: 08/07/2013
	CHECK NO:	3788	
	NAME:	ARNOLD FAMILY TRUST L CLARK ARNOLD TTEE ARDITH 7400 N ORACLE RD TUCSON AZ 85704-6331 US	

REMARKS

This receipt was generated by the automated BLM Collections and Billing System and is a paper representation of a portion of the official electronic record contained therein.

AMC 406366 AMC 406869

406767

407176

406787

412220

## AVEN Associates LLC

L. Clark Arnold  
Alan F. Edwards  
Frank J. Nelson  
Steven D. Van Nort

7400 North Oracle Road  
Suite 131  
Tucson, Arizona 85704  
520 797-1393  
520 742-7280  
[aven@theriver.com](mailto:aven@theriver.com)

July 2, 2012

U.S. Department of the Interior  
Bureau of Land Management  
Arizona State Office  
One North Central Ave. Suite 800  
Phoenix, AZ 85004-4427

### Re: Mining claim Maintenance Fees for Assessment Year Ending September 1, 2013

Ladies/Gentlemen,

Enclosed please find our check #2150 in the amount of \$6,580.00 to cover maintenance fees of \$140.00 each for the 47 claims described on the claim list (Exhibit A) attached hereto.

This letter is evidence of owner's intention to hold such claims through the assessment year ending on September 1, 2013.

Please return receipts and date stamped copies to me at the above address. If questions arise regarding this filing please get in touch using the information provided above.

Sincerely,



L. Clark Arnold  
AVEN Associates LLC

ENTERED INTO COMPUTER

JUL 19 2012 PB

PHOENIX, ARIZONA

2012 JUL -6 P 1:47

RECEIVED  
BLM AZ STATE OFFICE

**Exhibit A**

Claim	AMC Number	County	Claim	AMC Number	County
Bouse #1	AMC406366	La Paz	B-50	AMC412220	La Paz
Bouse #2	AMC406367	La Paz	B-51	AMC412221	La Paz
Bouse #3	AMC406368	La Paz	B-52	AMC412222	La Paz
Bouse #4	AMC406369	La Paz	B-53	AMC412223	La Paz
Bouse #5	AMC406370	La Paz	B-54	AMC412224	La Paz
Bouse #6	AMC406371	La Paz	B-55	AMC412225	La Paz
Bouse #7	AMC406372	La Paz	B-56	AMC412226	La Paz
Bouse #8	AMC406373	La Paz	B-57	AMC412227	La Paz
Bouse #9	AMC406767	La Paz	B-58	AMC412228	La Paz
Bouse #10	AMC406768	La Paz	B-59	AMC412229	La Paz
Bouse #11	AMC406769	La Paz	B-60	AMC412230	La Paz
Bouse #12	AMC406787	La Paz	B-61	AMC412231	La Paz
Bouse #13	AMC406788	La Paz	B-62	AMC412232	La Paz
Bouse #14	AMC406789	La Paz	B-63	AMC412233	La Paz
Bouse #15	AMC406790	La Paz	B-64	AMC412234	La Paz
Bouse #16	AMC406791	La Paz	B-65	AMC412235	La Paz
Bouse #17	AMC406792	La Paz			
Bouse #18	AMC406793	La Paz			
Bouse #30	AMC406874	La Paz			
Bouse #31	AMC406873	La Paz			
Bouse #32	AMC406872	La Paz			
Bouse #33	AMC406871	La Paz			
Bouse #34	AMC406870	La Paz			
Bouse #35	AMC406869	La Paz			
Bouse #36	AMC407176	La Paz			
Bouse #37	AMC407177	La Paz			
Bouse #38	AMC407178	La Paz			
Bouse #39	AMC407179	La Paz			
Bouse #40	AMC407180	La Paz			
Bouse #41	AMC407181	La Paz			
Bouse #42	AMC407182	La Paz			

**ENTERED INTO COMPUTER**  
 JUL 19 2012 PB

NO. OF CLAIMS 47  
 AMOUNT \$6580.00  
 RECEIPT NO. 2604564  
 INIT. D.A.  
 \*\* BLM-ASO\*\*

RECEIVED  
 BLM AZ STATE OFFICE  
 2012 JUL -6 P 1:47  
 PHOENIX, ARIZONA

~~NO. OF  
 AMOUNT  
 RECEIPT NO.  
 INIT.  
 \*\* BLM-ASO\*\*~~

AVEN Associates LLC  
7400 N. Oracle Road, #131  
Tucson, AZ 85704



US Bureau of Land Management  
One North Central Ave  
Suite 800  
Phoenix, AZ 85004

RECEIVED  
BLM AZ STATE OFFICE  
2012 JUL -6 P 1:47  
PHOENIX, ARIZONA

ATTN: MINING CLAIM ASSEM. FEES 85004+4427





AVEN Associates LLC  
7400 N. Oracle Road, #131  
Tucson, AZ 85704

TUCSON AZ 85704

POSTAGE WILL BE PAID BY ADDRESSEE



US Bureau of Land Management  
One North Central Ave  
Suite 800  
Phoenix, AZ 85004

RECEIVED  
BLM AZ STATE OFFICE  
2012 JUL -6 P 1:47  
PHOENIX, ARIZONA

ATTN: MINING CLAIM ASSEM. FEES 85004+4437



**United States Department of the Interior**  
**Bureau of Land Management**  
 LANDS/RECREATION & PLANNING  
 ONE N CENTRAL AVE  
 PHOENIX, AZ 85004 -2203  
 Phone: 602-417-9200

Receipt

No: 2604564

Transaction #: 2684622		<b>ENTERED INTO COMPUTER</b>
Date of Transaction: 07/09/2012		
CUSTOMER:		JUL 19 2012 <i>PB</i>
AVEN ASSOCIATES 7400 N ORACLE RD #131 TUCSON, AZ 85704 US		

LINE #	QTY	DESCRIPTION	REMARKS	UNIT PRICE	TOTAL
1	1.00	LOCATABLE MINERALS / MINING CLAIMS-NOT NEW-UNADJUD, ONE AUTH NO. ONLY / MINING CLAIM MONEY RECEIVED <b>CASES: AMC406366/\$6580.00</b>	MAINT FEE PYMNT (47) 2013	- n/a -	6580.00
<b>TOTAL:</b>					<b>\$6,580.00</b>

PAYMENT INFORMATION			
1	AMOUNT:	6580.00	POSTMARKED: N/A
	TYPE:	CHECK	RECEIVED: 07/09/2012
	CHECK NO:	2150	
	NAME:	AVEN ASSOCIATES 7400 N ORACLE RD #131 TUCSON AZ 85704 US	

REMARKS

This receipt was generated by the automated BLM Collections and Billing System and is a paper representation of a portion of the official electronic record contained therein.

*Lead file No.*

AMC 406366 - 373 406767 - 769 406787 - 793 406869 - 874 407176 - 182 412220 - 235	406366 406767 406787 406869 407176 412220	} ALL LOBE CLAIMS 20.66 Acres each PB
--	--	---

Message:

47 ROWS RETRIEVED

CBS Export Results Report

Include Resolved Records

Record Status

- Error Records (E/M/I)
- Accepted Records (A/W)
- "On Hold" Records (H)
- All Records (for s/n or receipt nr)
- Exported, No Results From CBS
- New (not yet exported)

Enter export Date (mm/dd/yyyy)

Serial Number match (optional)

Receipt Nr (optional)

Export Nr (exclusive)

LR2000 User (defaults to login)

Responsible Area (Errors Only)

- User (U,X)
- Programmer (P,X)
- All (U,P,X)

[User Guide](#)

	Resend?	Export Nr	A/D	Serial Nr	Mult	Code	S Amount	Remarks	Receipt Nr	LR2000 User	#Msg	Resolved?	OK	Stat1	Area	CBS Msg 1	Stat2	Area	Msg 2	CBS 392 ID	392 S Amt	Action Update Date	Resend	Resend Orig
1	<input type="checkbox"/>	3536618	A	AMC406366	682	140.00	2013	2604564	PAULINEB			<input type="checkbox"/>								1803878	6580.00	7/19/2012 12:27		
2	<input type="checkbox"/>	3536619	A	AMC406367	682	140.00	2013	2604564	PAULINEB			<input type="checkbox"/>								1803878	6580.00	7/19/2012 12:27		
3	<input type="checkbox"/>	3536620	A	AMC406368	682	140.00	2013	2604564	PAULINEB			<input type="checkbox"/>								1803878	6580.00	7/19/2012 12:27		
4	<input type="checkbox"/>	3536621	A	AMC406369	682	140.00	2013	2604564	PAULINEB			<input type="checkbox"/>								1803878	6580.00	7/19/2012 12:27		
5	<input type="checkbox"/>	3536622	A	AMC406370	682	140.00	2013	2604564	PAULINEB			<input type="checkbox"/>								1803878	6580.00	7/19/2012 12:27		
6	<input type="checkbox"/>	3536623	A	AMC406371	682	140.00	2013	2604564	PAULINEB			<input type="checkbox"/>								1803878	6580.00	7/19/2012 12:27		
7	<input type="checkbox"/>	3536624	A	AMC406372	682	140.00	2013	2604564	PAULINEB			<input type="checkbox"/>								1803878	6580.00	7/19/2012 12:27		
8	<input type="checkbox"/>	3536625	A	AMC406373	682	140.00	2013	2604564	PAULINEB			<input type="checkbox"/>								1803878	6580.00	7/19/2012 12:27		
9	<input type="checkbox"/>	3536626	A	AMC406767	682	140.00	2013	2604564	PAULINEB			<input type="checkbox"/>								1803878	6580.00	7/19/2012 12:28		
10	<input type="checkbox"/>	3536627	A	AMC406768	682	140.00	2013	2604564	PAULINEB			<input type="checkbox"/>								1803878	6580.00	7/19/2012 12:28		
11	<input type="checkbox"/>	3536628	A	AMC406769	682	140.00	2013	2604564	PAULINEB			<input type="checkbox"/>								1803878	6580.00	7/19/2012 12:28		
12	<input type="checkbox"/>	3536629	A	AMC406787	682	140.00	2013	2604564	PAULINEB			<input type="checkbox"/>								1803878	6580.00	7/19/2012 12:29		
13	<input type="checkbox"/>	3536630	A	AMC406788	682	140.00	2013	2604564	PAULINEB			<input type="checkbox"/>								1803878	6580.00	7/19/2012 12:29		
14	<input type="checkbox"/>	3536631	A	AMC406789	682	140.00	2013	2604564	PAULINEB			<input type="checkbox"/>								1803878	6580.00	7/19/2012 12:29		
15	<input type="checkbox"/>	3536632	A	AMC406790	682	140.00	2013	2604564	PAULINEB			<input type="checkbox"/>								1803878	6580.00	7/19/2012 12:29		
16	<input type="checkbox"/>	3536633	A	AMC406791	682	140.00	2013	2604564	PAULINEB			<input type="checkbox"/>								1803878	6580.00	7/19/2012 12:29		
17	<input type="checkbox"/>	3536634	A	AMC406792	682	140.00	2013	2604564	PAULINEB			<input type="checkbox"/>								1803878	6580.00	7/19/2012 12:29		
18	<input type="checkbox"/>	3536635	A	AMC406793	682	140.00	2013	2604564	PAULINEB			<input type="checkbox"/>								1803878	6580.00	7/19/2012 12:29		
19	<input type="checkbox"/>	3536636	A	AMC406869	682	140.00	2013	2604564	PAULINEB			<input type="checkbox"/>								1803878	6580.00	7/19/2012 12:30		
20	<input type="checkbox"/>	3536637	A	AMC406870	682	140.00	2013	2604564	PAULINEB			<input type="checkbox"/>								1803878	6580.00	7/19/2012 12:30		

Amc 409657

Amc 406366

Amc 406767

Amc 406787

# AVEN Associates LLC

L. Clark Arnold  
Alan F. Edwards  
Frank J. Nelson  
Steven D. Van Nort

7400 North Oracle Road  
Suite 131  
Tucson, Arizona 85704  
520 797-1393  
520 742-7280  
aven@theriver.com

August 20, 2011

Amc 406869  
Amc 407176

United States Department of the Interior  
Bureau of Land Management  
Arizona State Office  
One North Central Avenue, Suite 800  
Phoenix, AZ 85004-4427

**RE: Mining Claim Maintenance Fees for Assessment Year Ending September 1, 2012.**

Dear Sir or Madam,

Enclosed is a check in the amount of \$5040.00, which serves as payment of the Maintenance Fees of \$140.00 for each of the 36 unpatented claims described on the claim list (Exhibit A) attached hereto.

This letter is evidence of owner's intention to hold such claims through the assessment year ending on September 1, 2011.

<u>Claim Group</u>	<u>County</u>	<u>Number of Claims</u>
Peg Leg	Pinal	5
Bouse	La Paz	31
	<b>Total Claims</b>	<b>36</b>

Please return receipts and date stamped copies to me at the above address. If you have any questions concerning this filing please call me at the number listed above.

Sincerely,

\_\_\_\_\_  
L. Clark Arnold

NO. OF CLAIMS 36  
AMOUNT 5040.00  
RECEIPT NO. 2407034  
INIT. [Signature]  
\*\* BLM-ASO \*\*

AUG 26 2011 cm

RECEIVED  
BLM AZ STATE OFFICE  
2011 AUG 17 A 8:07  
PHOENIX, ARIZONA

20-Aug-11

Exhibit A

Claim	MC Number	County
Peg Leg	PL-6	AMC409657 Pinal
	PL-7	AMC409658 Pinal
	PL-12	AMC409659 Pinal
	PL-27	AMC409660 Pinal
	PL-31	AMC409661 Pinal

51

Claim	MC Number	County
Bouse	Bouse #1	AMC406366 La Paz
	Bouse #2	AMC406367 La Paz
	Bouse #3	AMC406368 La Paz
	Bouse #4	AMC406369 La Paz
	Bouse #5	AMC406370 La Paz
	Bouse #6	AMC406371 La Paz
	Bouse #7	AMC406372 La Paz
	Bouse #8	AMC406373 La Paz
	Bouse #9	AMC406767 La Paz
	Bouse #10	AMC406768 La Paz
	Bouse #11	AMC406769 La Paz
	Bouse #12	AMC406787 La Paz
	Bouse #13	AMC406788 La Paz
	Bouse #14	AMC406789 La Paz
	Bouse #15	AMC406790 La Paz
	Bouse #16	AMC406791 La Paz
	Bouse #17	AMC406792 La Paz
	Bouse #18	AMC406793 La Paz
	Bouse #30	AMC406874 La Paz
	Bouse #31	AMC406873 La Paz
	Bouse #32	AMC406872 La Paz
	Bouse #33	AMC406871 La Paz
	Bouse #34	AMC406870 La Paz
	Bouse #35	AMC406869 La Paz
	Bouse #36	AMC407176 La Paz
	Bouse #37	AMC407177 La Paz
	Bouse #38	AMC407178 La Paz
	Bouse #39	AMC407179 La Paz
	Bouse #40	AMC407180 La Paz
	Bouse #41	AMC407181 La Paz
	Bouse #42	AMC407182 La Paz

31

PHOENIX, ARIZONA

2011 AUG 17 A 8:07

RECEIVED  
BLM AZ STATE OFFICE

AVEN Associates LLC  
7400 N. Oracle Rd #131  
Tucson, AZ 85704



RETURN RECEIPT  
REQUESTED

United States Department of the Interior  
Bureau of Land Management  
Arizona State Office  
One North Central Avenue  
Suite 800  
Phoenix, AZ 85004-4427

RECEIVED  
BLM STATE OFFICE  
2011 AUG 15 P 1:51  
PHOENIX, ARIZONA

United States Department of the Interior  
 Bureau of Land Management  
 LANDS/RECREATION & PLANNING  
 ONE N CENTRAL AVE  
 PHOENIX, AZ 85004 -2203  
 Phone: 602-417-9200

Receipt

No: 2407034

<b>Transaction #:</b> 2482310	
<b>Date of Transaction:</b> 08/17/2011	
<b>CUSTOMER:</b>	
AVEN ASSOCIATES 7400 N ORACLE RD #131 TUCSON, AZ 85704 US	

LINE #	QTY	DESCRIPTION	REMARKS	UNIT PRICE	TOTAL
1	1.00	LOCATABLE MINERALS / MINING CLAIMS-NOT NEW-UNADJUD, ONE AUTH NO. ONLY / MINING CLAIM MONEY RECEIVED CASES: AMC409657/\$5040.00	MAINT-36	- n/a -	5040.00
<b>TOTAL:</b>					<b>\$5,040.00</b>

PAYMENT INFORMATION					
1	AMOUNT:	5040.00	POSTMARKED:	08/15/2011	
	TYPE:	CHECK	RECEIVED:	08/17/2011	
	CHECK NO:	1871			
	NAME:	AVEN ASSOCIATES LLC 7400 N ORACLE RD #131 TUCSON AZ 85704 US			

REMARKS

This receipt was generated by the automated BLM Collections and Billing System and is a paper representation of a portion of the official electronic record contained therein.

**NOTICE!!**

**These documents have been scanned!**

**Do not place un-scanned documents beneath this notice!**

**Do not remove this notice from this file!**

GPO Jacket No. 560-102  
Print Order 61540  
Rise Business Services, LLC  
Job=AZ15 5/16/2019



Box Number= AZ15059



Claim Begin-End: AMC406366-AMC406373

6 Location Notices-Amendments and Supporting Documents



AZ15059-2

AMC406356-AMC407176



# MINING CLAIM STATUS REPORT

DATA

ENTERED MAR 28 2011 PP

MTP Checked by MAR 28 2011 CB

GEO Checked by MAR 28 2011 CB

LEAD SERIAL NUMBER AMC 406366 thru AMC 406373

## # OF CLAIMS & TYPE

# 8 LODE

# \_\_\_\_\_ PLACER

# \_\_\_\_\_ ASSOCIATION PLACER

# \_\_\_\_\_ MILL SITE

# \_\_\_\_\_ TUNNEL SITE

## CHARGES

Location Fee @ \$34 = \$ \_\_\_\_\_

Processing Fee @ \$15 = \$ \_\_\_\_\_

Maintenance Fee @ \$140 = \$ \_\_\_\_\_

Overage (+) \$ \_\_\_\_\_

Shortage (-) \$ \_\_\_\_\_

Other Fees \$ \_\_\_\_\_

**TOTAL** \$ \_\_\_\_\_

ARE THERE ENOUGH LOCATORS?

Yes ( ) No ( ) \_\_\_\_\_

DOCUMENTS RECEIVED VIA -

Over-the-Counter ( ) Mail (  )

TIMELY FILED?

Yes (  ) No ( )

LEGAL DESCRIPTION - T 7N R 17W SEC 18

T \_\_\_\_\_ R \_\_\_\_\_ SEC \_\_\_\_\_

T \_\_\_\_\_ R \_\_\_\_\_ SEC \_\_\_\_\_

T \_\_\_\_\_ R \_\_\_\_\_ SEC \_\_\_\_\_

BLM ( ) FOREST SERVICE ( ) \_\_\_\_\_ SUBJ TO PL 359: Yes ( ) No ( )

WILDERNESS AREA: No ( ) Yes ( ) \_\_\_\_\_

SPLIT ESTATE - N/A ( ) SX ( ) PX ( ) SRHA ( ) OTHER ( ) \_\_\_\_\_

Proper Notice Filed if Located on SHRA Lands? N/A ( ) Yes ( ) No ( )

RECONVEYED MINERALS ON BLM LANDS REQUIRE OPENING ORDERS FROM 1944 TO 1993 -

Open to Entry on: \_\_\_\_\_ N/A ( )

COMMENTS/STATUS - VOID ( ) PARTIALLY VOID ( ) PVT MINERALS ( ) WITHDRAWN LANDS ( )

OTHER ( ) \_\_\_\_\_

Claimant acknowledges that portions of the following claims(s) site(s) may be void or voidable.

Printed Name of Claimant \_\_\_\_\_ Signature of Claimant \_\_\_\_\_

\*\*\*\*\* FINAL ADJUDICATION \*\*\*\*\*

DATE 6/29/2011 INITIALS LS

AMC 406366

Recorded at the Request of:

When recorded mail to:  
Merrill Palmer  
128 SUNRAY DR.  
LAKE HAVASU CITY  
86403

RECEIVED  
LAKE HAVASU STATE OFFICE  
2011 MAR 15 A 11:11  
PHOENIX ARIZONA

### NOTICE OF MINING CLAIM LOCATION

1.  Location     Amendment    *Check one only*
2.  Placer     Lode     Millsite     Tunnelsite    *Check one only*
3. The name and address of the Locator is Merrill Palmer  

	Name
<u>128 SUNRAY DR.</u>	<u>ARIZONA</u>
Address	State
<u>LAKE HAVASU CITY</u>	<u>86403</u>
City	Zip
4. The name of the claim is Bouse #1
5. The date of the location is Dec 16, 2010
6. The type of location monument is 2"x2"x5' wood Post
7. The type of corner and end monument is 2"x2"x5' wood Post
8. The claim is 1500 feet long and 600 feet wide. The Distance from the location monument to each end of the claim is 10 feet in a South direction and 1490 feet in a North direction.
9. The general course is from the North to the South.
10. The location of the claim occupies all or part of the following quarter sections:

Quarter Section(s)	Section(s)	Township(s)	Range(s)
<u>NE 1/4</u>	<u>18</u>	<u>T7N</u>	<u>R 17 W</u>
_____	_____	_____	_____
_____	_____	_____	_____
11. The locality of this claim with reference to some natural object or permanent monument and additional information (if any) concerning its locality are as follows:  
The NE corner of this claim is about 2000 FT. west of the corner monument for sections 7, 8, 12, 18 T7N R17W
12. If amending, the previous claim name was \_\_\_\_\_ recorded in Docket \_\_\_\_\_, Book \_\_\_\_\_ Mining District, \_\_\_\_\_ County, Arizona.

Date Dec. 16, 2010

Merrill Palmer  
Signature

AMC 406366

# MAP OF MINING CLAIM LOCATION

1. The name of the claim is Bouse # 1
2. Type of claim is     Placer     Lode     Millsite     Tunnelsite    *Check only one*
3. The NE corner of the claim is about 2000 feet in a EAST direction to a survey monument ~~or point~~ described as CORNER FOR SECTIONS 7, 8, 18, 17 T7N R17W
4. The bearing and distance between the corners of the claim are beginning at the NW corner of the claim, 600 feet in a EAST direction to the NE corner, then 1500 feet in a South direction to the SE corner, then 600 feet in west direction to the SW corner, then 1500 feet in a North direction to the point of beginning.

## MAP

One inch = Two thousand feet

North arrow

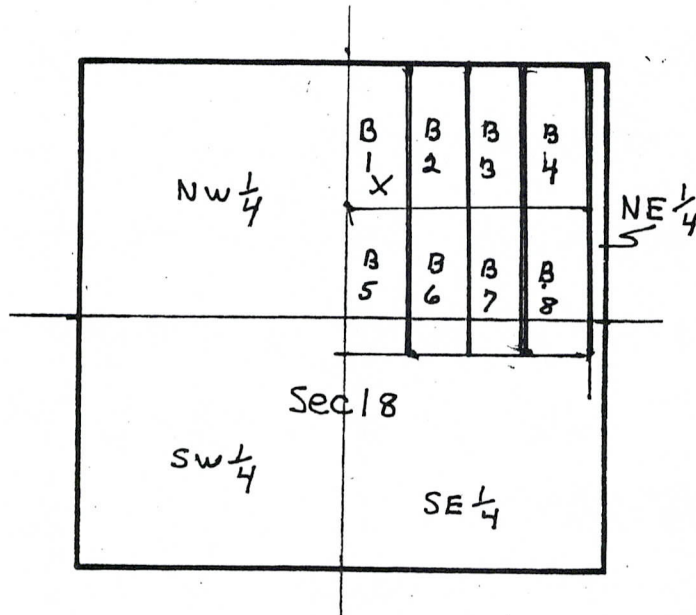

PHOENIX, ARIZONA

2011 MAR 15 A 11:16

RECEIVED  
PHOENIX STATE OFFICE

Section 18 Township T 7 N Range R 17 W G & SRB & M

Date Dec 16<sup>th</sup> 2010

Merrill Palmer  
Signature

ANC 406366

Recorded at the Request of:

When recorded mail to:  
Merrill Palmer  
128 SUNRAY DR.  
LAKE HAVASU CITY  
86403

PHOENIX ARIZONA

2011 MAR 15 A 11:16

RECEIVED  
STATE OFFICE

# NOTICE OF MINING CLAIM LOCATION

- Location     Amendment    *Check one only*
- Placer     Lode     Millsite     Tunnelsite    *Check one only*
- The name and address of the Locator is Merrill Palmer  

	Name	
<u>128 Sunray Dr.</u>	<u>LAKE HAVASU CITY</u>	<u>ARIZONA</u>
Address	City	State
	Zip	<u>86403</u>
- The name of the claim is House #2
- The date of the location is Dec 16<sup>th</sup>, 2010
- The type of location monument is 2" x 2" x 5' wood Post
- The type of corner and end monument is 2" x 2" x 5' wood Post
- The claim is 1500 feet long and 600 feet wide. The Distance from the location monument to each end of the claim is 10 feet in a South direction and 1490 feet in a North direction.
- The general course is from the North to the South.
- The location of the claim occupies all or part of the following quarter sections:

Quarter Section(s)	Section(s)	Township(s)	Range(s)
<u>NE 1/4</u>	<u>18</u>	<u>T7N</u>	<u>R17W</u>
- The locality of this claim with reference to some natural object or permanent monument and additional information (if any) concerning its locality are as follows:  
The NE CORNER of This Claim is About 1400 FT WEST  
From The CORNER MONUMENT for Sections 7, 8, 17, 18, T7N  
R17W
- If amending, the previous claim name was \_\_\_\_\_ recorded in Docket \_\_\_\_\_, Book \_\_\_\_\_, Mining District \_\_\_\_\_, \_\_\_\_\_ County, Arizona.

Date Dec 16<sup>th</sup>, 2010

Merrill Palmer  
Signature

AMC 406367

# MAP OF MINING CLAIM LOCATION

- The name of the claim is Bouse # 2
- Type of claim is  Placer  Lode  Millsite  Tunnelsite *Check only one*
- The NE corner of the claim is about 1400 feet in a EAST direction to a survey monument ~~at the NE corner of the claim~~ described as CORNER FOR SECTIONS 7, 8, 18, 17 T7N R17W
- The bearing and distance between the corners of the claim are beginning at the NW corner of the claim, 600 feet in a EAST direction to the NE corner, then 1500 feet in a South direction to the SE corner, then 600 feet in west direction to the SW corner, then 1500 feet in a North direction to the point of beginning.

## MAP

One inch = Two thousand feet

North arrow

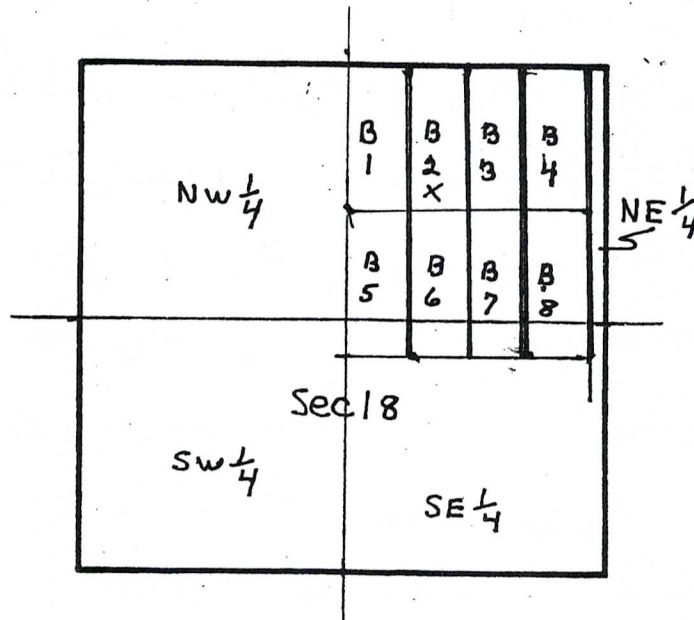

RECEIVED  
 ARIZONA STATE OFFICE  
 2011 MAR 15 A 11:16  
 PHOENIX, ARIZONA

AMC 406367

Section 18 Township T7N Range R17W G & SRB & M

Date Dec 16<sup>th</sup>, 2010

Merrill Palmer  
 Signature

Recorded at the Request of:

When recorded mail to:  
Merrill Palmer  
128 SUNRAY DR.  
LAKE HAVASU CITY  
86403

RECEIVED  
MINING STATE OFFICE  
2011 MAR 15 A 11:16  
PIEDMONT ARIZONA

### NOTICE OF MINING CLAIM LOCATION

1.  Location     Amendment    Check one only

2.  Placer     Lode     Millsite     Tunnelsite    Check one only

3. The name and address of the Locator is Merrill Palmer  
Name  
128 SUNRAY DR.    LAKE HAVASU CITY    ARIZONA    86403  
Address    City    State    Zip

4. The name of the claim is Bouse #3

5. The date of the location is Dec 16<sup>th</sup>, 2010

6. The type of location monument is 2"x2"x5' wood Post

7. The type of corner and end monument is 2"x2"x5' wood Post

8. The claim is 1500 feet long and 600 feet wide. The Distance from the location monument to each end of the claim is 10 feet in a South direction and 1490 feet in a North direction.

9. The general course is from the North to the South.

10. The location of the claim occupies all or part of the following quarter sections:

Quarter Section(s)	Section(s)	Township(s)	Range(s)
<u>NE 1/4</u>	<u>18</u>	<u>T7N</u>	<u>R17W</u>

11. The locality of this claim with reference to some natural object or permanent monument and additional information (if any) concerning its locality are as follows:

The NE CORNER of This Claim is About 750 FT west  
From The JOINT CORNER of Sections 7, 8, 17, 18, T7N,  
R17W

12. If amending, the previous claim name was \_\_\_\_\_ recorded in Docket \_\_\_\_\_, Book \_\_\_\_\_, Mining District \_\_\_\_\_, \_\_\_\_\_ County, Arizona.

Date Dec 16<sup>th</sup> 2010

Merrill Palmer  
Signature

AMC 406368

# MAP OF MINING CLAIM LOCATION

- The name of the claim is Bouse # 3
- Type of claim is  Placer  Lode  Millsite  Tunnelsite *Check only one*
- The NE corner of the claim is about 750 feet in a EAST direction to a survey monument ~~or see subject~~ described as CORNER FOR SECTIONS 7, 8, 18, 17 T7N R17W
- The bearing and distance between the corners of the claim are beginning at the NW corner of the claim, 600 feet in a EAST direction to the NE corner, then 1500 feet in a South direction to the SE corner, then 600 feet in a west direction to the SW corner, then 1500 feet in a North direction to the point of beginning.

## MAP

One inch = Two thousand feet

North arrow

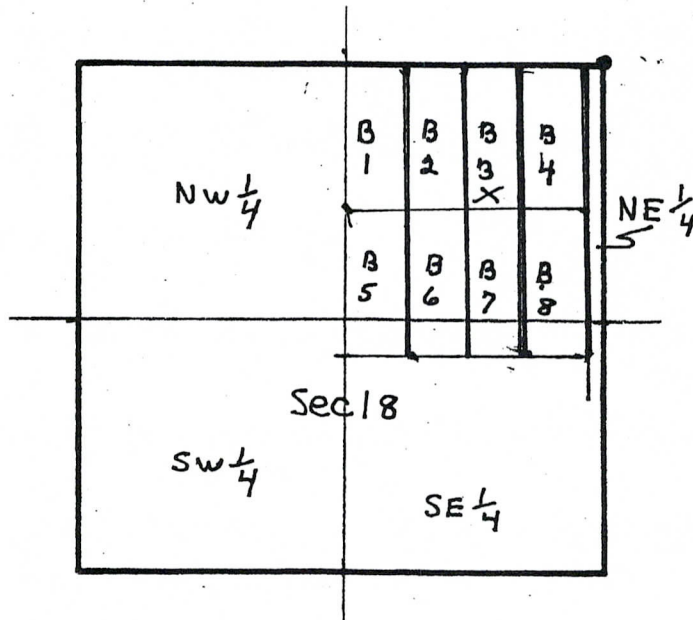

PHOENIX, ARIZONA

2011 MAR 15 A 11:16

RECEIVED  
STATE OFFICE

Section 18 Township T7N Range R17W G & SRB & M

Date Dec 16, 2010

Merrill Palmer  
Signature

ANC 406368

Recorded at the Request of:

When recorded mail to:  
Merrill Palmer  
128 SUNRAY DR.  
LAKE HAVASU CITY  
86403

RECEIVED  
MINE STATE OFFICE  
2011 MAR 15 A 11:16  
PHOENIX ARIZONA

### NOTICE OF MINING CLAIM LOCATION

- Location     Amendment    *Check one only*
- Placer     Lode     Millsite     Tunnelsite    *Check one only*
- The name and address of the Locator is Merrill Palmer  

<u>128 SUNRAY DR.</u>	<u>LAKE HAVASU CITY</u>	<u>ARIZONA</u>	<u>86403</u>
Address	City	State	Zip
- The name of the claim is Bouse # 4
- The date of the location is Dec. 16<sup>th</sup>, 2010
- The type of location monument is 2"x2"x5' wood Post
- The type of corner and end monument is 2"x2"x5' wood Post
- The claim is 1500 feet long and 600 feet wide. The Distance from the location monument to each end of the claim is 10 feet in a South direction and 1490 feet in a North direction.
- The general course is from the North to the South.
- The location of the claim occupies all or part of the following quarter sections:

Quarter Section(s)	Section(s)	Township(s)	Range(s)
<u>NE 1/4</u>	<u>18</u>	<u>T7N</u>	<u>R17W</u>
- The locality of this claim with reference to some natural object or permanent monument and additional information (if any) concerning its locality are as follows:  
The NE CORNER of This Claim is About 150 FT in a West  
direction from The JOINT CORNER of Sections 7, 8, 17, 18  
T7N, R17W.
- If amending, the previous claim name was \_\_\_\_\_ recorded in Docket \_\_\_\_\_, Book \_\_\_\_\_, Mining District, \_\_\_\_\_ County, Arizona.

Date Dec 16, 2010

Merrill Palmer  
Signature

AMC 406369



# MAP OF MINING CLAIM LOCATION

- The name of the claim is Bouse # 4
- Type of claim is  Placer  Lode  Millsite  Tunnelsite *Check only one*
- The NE corner of the claim is about 150 feet in an EAST direction to a survey monument ~~on the corner of the claim~~ described as CORNER FOR SECTIONS 7, 8, 18, 17 T7N R17W
- The bearing and distance between the corners of the claim are beginning at the NW corner of the claim, 600 feet in a EAST direction to the NE corner, then 1500 feet in a South direction to the SE corner, then 600 feet in west direction to the SW corner, then 1500 feet in a North direction to the point of beginning.

## MAP

One inch = Two thousand feet

North arrow

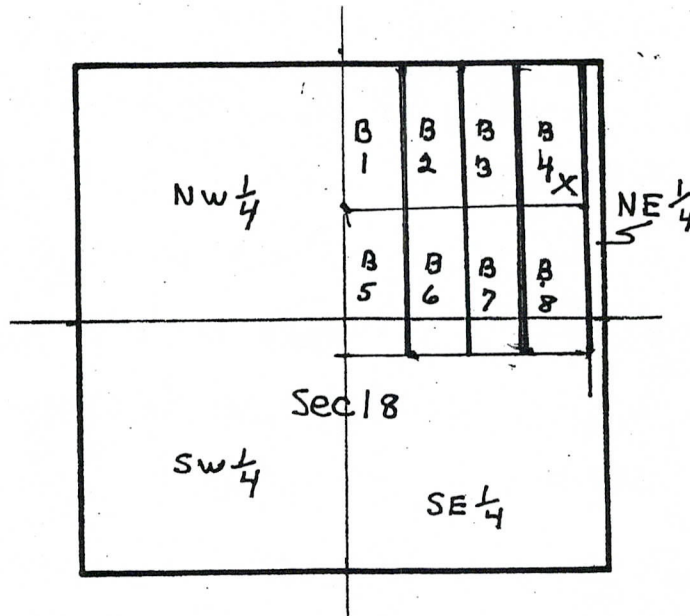

PHOENIX, ARIZONA

2011 MAR 15 A 11:16

RECEIVED  
LAND STATE OFFICE

Section 18 Township T7N Range R17W G & SRB & M

Date Dec 16, 2010

Merrill Palmer  
Signature

AMC 406369

Recorded at the Request of:

When recorded mail to:  
Merrill Palmer  
128 SUNRAY DR.  
LAKE HAVASU CITY  
86403

RECEIVED  
CLIMATE STATE OFFICE  
2011 MAR 15 A 11:16  
PHOENIX ARIZONA

# NOTICE OF MINING CLAIM LOCATION

1.  Location     Amendment    Check one only

2.  Placer     Lode     Millsite     Tunnelsite    Check one only

3. The name and address of the Locator is Merrill Palmer  
Name  
128 SUNRAY DR.    LAKE HAVASU CITY    ARIZONA    86403  
Address    City    State    Zip

4. The name of the claim is Bouse #5

5. The date of the location is Dec 16, 2010

6. The type of location monument is 2"x2"x5' wood Post

7. The type of corner and end monument is 2"x2"x5' wood Post

8. The claim is 1500 feet long and 600 feet wide. The Distance from the location monument to each end of the claim is 10 feet in a South direction and 1490 feet in a North direction.

9. The general course is from the North to the South.

10. The location of the claim occupies all or part of the following quarter sections:  
Quarter Section(s)    Section(s)    Township(s)    Range(s)  
NE 1/4 / SE 1/4    18    T7N    R17W

11. The locality of this claim with reference to some natural object or permanent monument and additional information (if any) concerning its locality are as follows:  
The NE CORNER of this claim is ABOUT 2500 FT in a SW direction from The JOINT CORNER of Sections 7, 8, 17, 18 T7N, R17W

12. If amending, the previous claim name was \_\_\_\_\_ recorded in Docket \_\_\_\_\_, Book \_\_\_\_\_ Mining District, \_\_\_\_\_ County, Arizona.

Date Dec 16<sup>th</sup> 2010

Merrill Palmer  
Signature

AMC 406370

# MAP OF MINING CLAIM LOCATION

- The name of the claim is Bouse # 5
- Type of claim is  Placer  Lode  Millsite  Tunnelsite *Check only one*
- The NE corner of the claim is about 2500 feet in a NE direction to a survey monument ~~at the NE corner of Section 18~~ described as CORNER For SECTIONS 7, 8, 18, 17 T7N R17W
- The bearing and distance between the corners of the claim are beginning at the NW corner of the claim, 600 feet in a EAST direction to the NE corner, then 1500 feet in a South direction to the SE corner, then 600 feet in west direction to the SW corner, then 1500 feet in a North direction to the point of beginning.

## MAP

One inch = Two thousand feet

North arrow

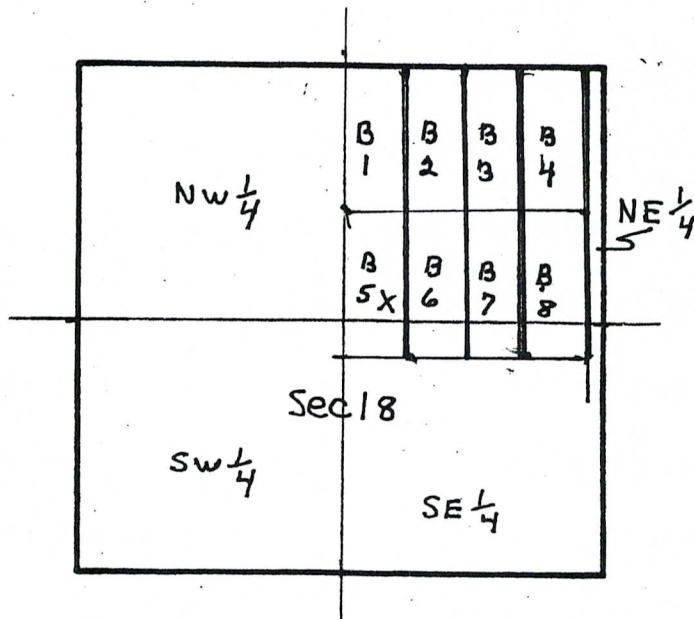

PHOENIX, ARIZONA

2011 MAR 15 A 11:16

RECEIVED  
STATE OFFICE

Section 18 Township T 7 N Range R 17 W G & SRB & M

Date Dec 16<sup>th</sup> 2010

Merrill Palmer  
Signature

AMC 406370



# MAP OF MINING CLAIM LOCATION

- The name of the claim is Bouse # 6
- Type of claim is  Placer  Lode  Millsite  Tunnelsite *Check only one*
- The NE corner of the claim is about 2100 feet in a NE direction to a survey monument ~~or point of interest~~ described as CORNER For Sections 7, 8, 18, 17 T7N R17W
- The bearing and distance between the corners of the claim are beginning at the NW corner of the claim, 600 feet in a EAST direction to the NE corner, then 1500 feet in a South direction to the SE corner, then 600 feet in a west direction to the SW corner, then 1500 feet in a North direction to the point of beginning.

## MAP

One inch = Two thousand feet

North arrow

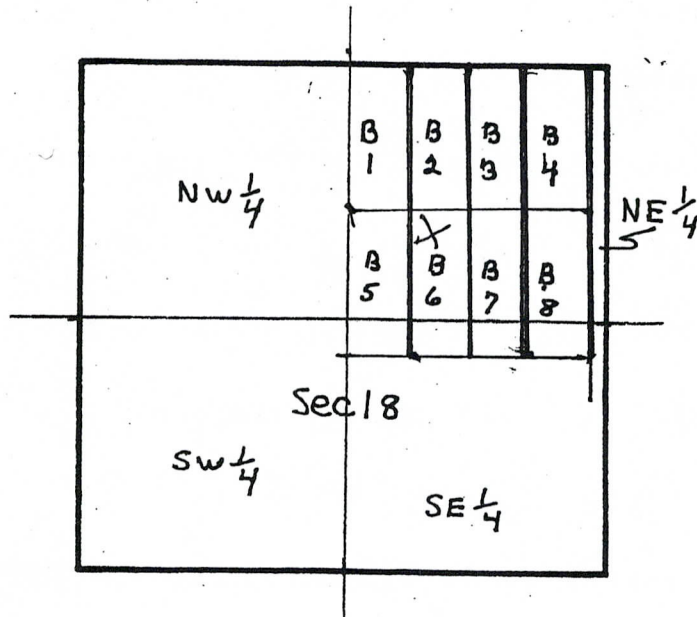

RECEIVED  
 LAND STATE OFFICE  
 PHOENIX, ARIZONA  
 2011 MAR 15 A 11:16

Section 18 Township T7N Range R17W G & SRB & M

Date Dec 16<sup>th</sup>, 2010

Merrill Palmer  
Signature

ANC 406371

Recorded at the Request of:

When recorded mail to:

Merrill Palmer  
128 SUNRAY DR.  
LAKE HAVASU CITY  
86403

RECEIVED  
PLM AZ STATE OFFICE  
2011 MAR 15 A 11:16  
PHOENIX, ARIZONA

# NOTICE OF MINING CLAIM LOCATION

- Location     Amendment    *Check one only*
- Placer     Lode     Millsite     Tunnelsite    *Check one only*
- The name and address of the Locator is Merrill Palmer  

	Name	
<u>128 SUNRAY DR.</u>	<u>LAKE HAVASU CITY</u>	<u>ARIZONA</u>
Address	City	State
		<u>86403</u>
		Zip
- The name of the claim is Bouse # 7
- The date of the location is Dec 16, 2010
- The type of location monument is 2'x 2'x 5' wood Post
- The type of corner and end monument is 2'x 2'x 5' wood Post
- The claim is 1500 feet long and 600 feet wide. The Distance from the location monument to each end of the claim is 10 feet in a South direction and 1490 feet in a North direction.
- The general course is from the North to the South.
- The location of the claim occupies all or part of the following quarter sections:

Quarter Section(s)	Section(s)	Township(s)	Range(s)
<u>NE 1/4 / SE 1/4</u>	<u>18</u>	<u>T 7 N</u>	<u>R 17 W</u>
_____	_____	_____	_____
_____	_____	_____	_____
- The locality of this claim with reference to some natural object or permanent monument and additional information (if any) concerning its locality are as follows:  
The NE CORNER of This Claim is About 1750 FT IN A ~~SW~~ SW  
direction From The JOINT CORNER OF SECTIONS 7, 8, 17, 18  
T 7 N, R 17 W.
- If amending, the previous claim name was \_\_\_\_\_ recorded in Docket \_\_\_\_\_, Book \_\_\_\_\_, Mining District, \_\_\_\_\_ County, Arizona.

Date Dec 16, 2010

Merrill Palmer  
Signature

AMC 406372

# MAP OF MINING CLAIM LOCATION

- The name of the claim is Bouse # 7
- Type of claim is  Placer  Lode  Millsite  Tunnelsite *Check only one*
- The NE corner of the claim is about 1750 feet in a NE direction to a survey monument ~~or point of reference~~ described as CORNER FOR SECTIONS 7, 8, 18, 17 T7N R17W
- The bearing and distance between the corners of the claim are beginning at the NW corner of the claim, 600 feet in a EAST direction to the NE corner, then 1500 feet in a South direction to the SE corner, then 600 feet in west direction to the SW corner, then 1500 feet in a North direction to the point of beginning.

## MAP

One inch = Two thousand feet

North arrow

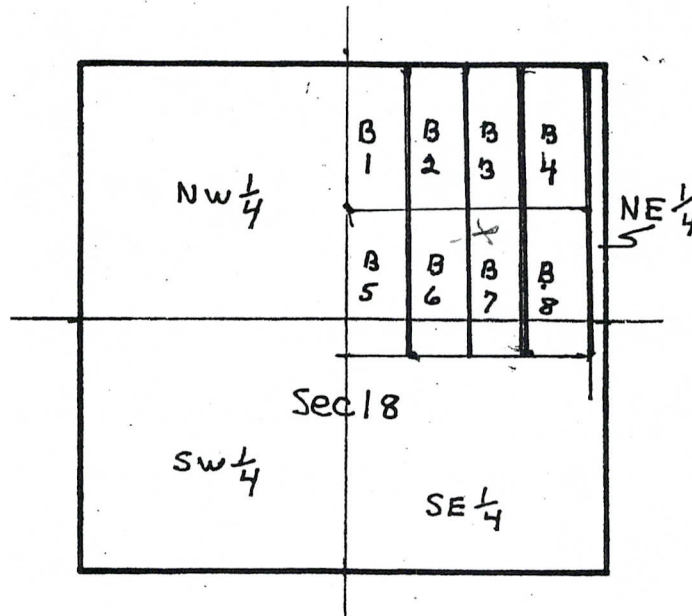

PHOENIX, ARIZONA

2011 MAR 15 A 11:16

RECEIVED  
MINAZ STATE OFFICE

AMC 406312

Section 18 Township T 7 N Range R 17 W G & SRB & M

Date Dec 16, 2010

Merill Palmer  
Signature





# MAP OF MINING CLAIM LOCATION

- The name of the claim is Bouse # 8
- Type of claim is  Placer  Lode  Millsite  Tunnelsite *Check only one*
- The NE corner of the claim is about 1650 feet in a NE direction to a survey monument ~~or point of interest~~ described as CORNER For Sections 7, 8, 18, 17 T7N R17W
- The bearing and distance between the corners of the claim are beginning at the NW corner of the claim, 600 feet in a EAST direction to the NE corner, then 1500 feet in a South direction to the SE corner, then 600 feet in west direction to the SW corner, then 1500 feet in a North direction to the point of beginning.

## MAP

One inch = Two thousand feet

North arrow

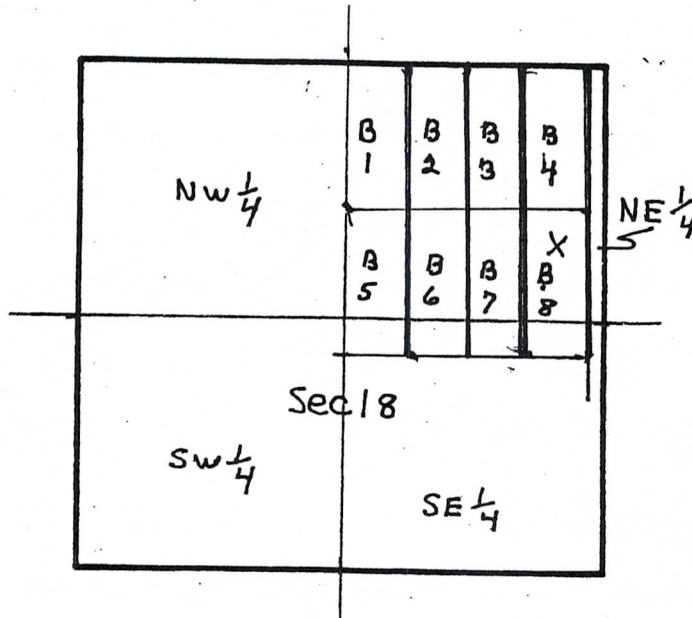

PHOENIX, ARIZONA

2011 MAR 15 A 11:15

RECEIVED  
LAND STATE OFFICE

Section 18 Township T 7 N Range R 17 W G & SRB & M

Date Dec 16<sup>th</sup>, 2010

Merrill Palmer  
Signature

AMC 406373

RUN TIME: 10:39 AM

Adm State: AZ

UNITED STATES DEPARTMENT OF INTERIOR  
BUREAU OF LAND MANAGEMENT  
GEOGRAPHIC REPORT WITH LAND  
Sorted by Meridian Township Range

RUN DATE: 03/28/2011  
Page 1 of 1

Serial Number: AZA 033154

Total Case Acres: 0.050

<u>Casetype</u>	<u>Case Disp</u>				<u>Sect</u>	<u>Sur Typ</u>	<u>Sur Num</u>	<u>Suff</u>	<u>Subdivision</u>	<u>Act Pend</u>
380913	AUTHORIZED	14	0070N	0170W	018	MNR			E2NENW;	

DEPARTMENT OF INTERIOR  
BUREAU OF LAND MANAGEMENT

Input Parameters for Geographic Report with Land

System Id = CR

Admin State = AZ

Geo State = AZ

Casetype Begins With

Case Disp Txt = AUTHORIZED, CANCELLED, EXPIRED, PENDING, REJECTED, RELINQUISHED, WITHDRAWN

Mer Twp Rng =

Section =

Mtrs = 14 0070N 0170W 018, 14 0070N 0170W 999

Commodity =

Commodity Txt =

Pending Org =

Pend Org Decode =

Total Rows Returned: 1

